

NOTES:

- 1. MATERIAL: BAR, 316/321 S.S.,  $\phi 2.765 \times 0.615$  LG.
- 2. HEAT TREAT: NONE
- 3. SURFACE TREATMENT: NONE
- 4. WEIGHT: 0.46 LB.

REVISIONS				
NO	DESCRIPTION	DATE	BY	APR/DATE
0	ISSUED FOR MANUFACTURE	05/12/10		

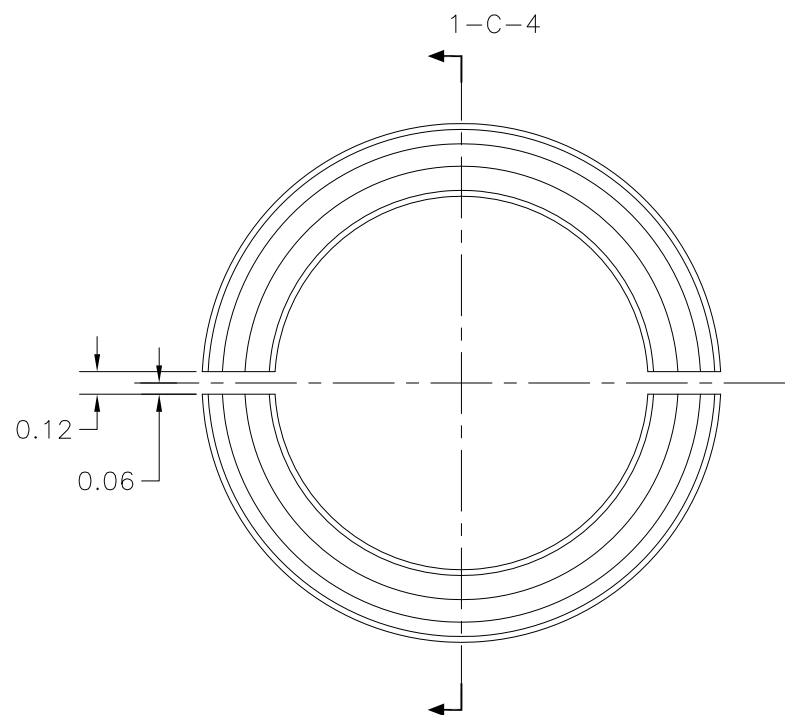

VIEW 1-C-6  
UPPER SINKER BAR SPLIT RING

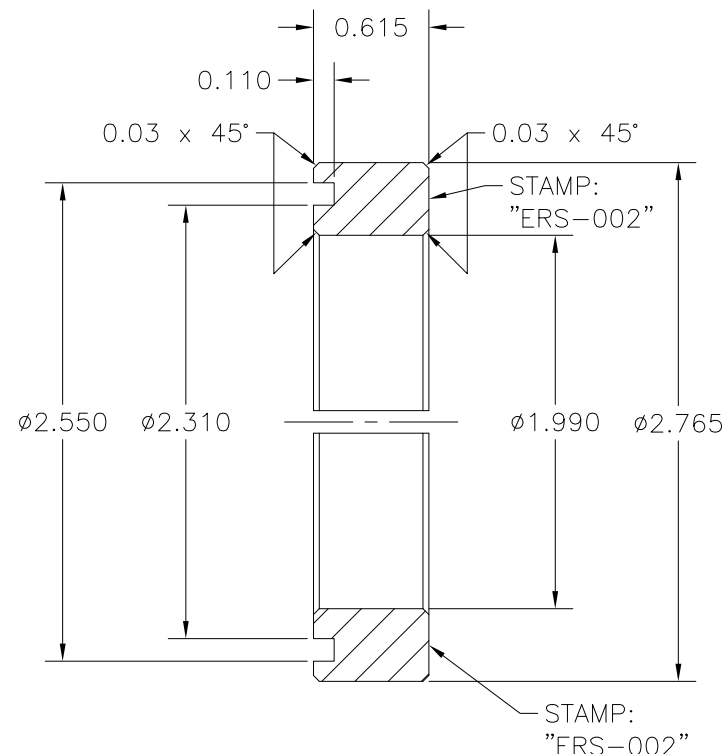

SECTION 1-C-4  
REF. 1-C-6

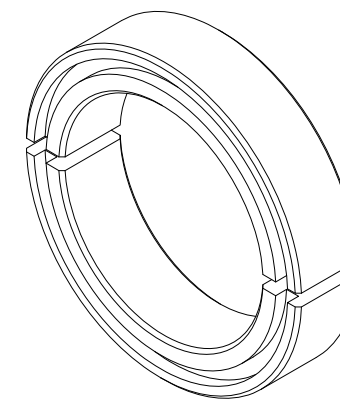

PICTORIAL 1-C-2  
UPPER SINKER BAR SPLIT RING  
N.T.S.

TOLERANCES: UNLESS OTHERWISE SPECIFIED 0.X $\pm$ 0.030 0.XX $\pm$ 0.010 0.XXX $\pm$ 0.005 ANGLES $\pm$ 1/2' BREAK EDGES 0.015 x 45° MIN. FINISH $\sqrt{125}$ $\sqrt{0.010}$ A ALL DIMS ARE IN INCHES, UNLESS NOTED OTHERWISE.	PROPRIETARY NOTICE THIS DRAWING AND THE INFORMATION IT CONTAINS ARE CONSIDERED CONFIDENTIAL, AND MAY NOT BE REPRODUCED, COPIED OR USED, IN PART OR IN WHOLE, WITHOUT PRIOR WRITTEN CONSENT.	<b>Integrated Ocean Drilling Program</b> TEXAS A&M UNIVERSITY 1000 DISCOVERY DRIVE COLLEGE STATION, TX 77845			
		SHEET 1 OF 1 SCALE 1:2 BY KM DATE 03/30/10		TITLE UPPER SINKER BAR SPLIT RING SYSTEM ASSEMBLY 3" ERS APPROVED TP CHECKED JCS SIZE D P/N ERS-002 REV. 0	